



SMD Power Inductors -KMG Series

● FEATURES 特性

1.表面贴装,小型、超薄电感器,大功率,高饱和,低电阻之特性.

The inductor designed as surface mounting, smallest and thinnest with high power, high saturation and low resistance

2.磁性胶水涂敷结构极大减少了噪声,闭合磁路结构设计,漏磁少,抗EMI能力强.

Magnetic-resin shielded structure reduces buzz noise to ultra-low levels, Closed magnetic circuit structure reduces magnetic leakage flux, high performance of anti-EMI.

3.同等尺寸额定电流较传统电感高出30%以上.

Compared with the same size part, the rated current 30% higher than the traditional inductors.

4.工作频率范围广,可达5MHz以上. Wide range working frequency that reach more than 5MHz

5.RoHS, 无卤环保产品. RoHS, Halogen-free environmental protection products



● APPLICATIONS 用途

1. LED Lighting LED 照明

2. Automotive systems 汽车产品

3. Notebooks, desktop computers, servers, graphic cards 笔记本电脑, 台式电脑, 服务器, 显卡

● PART NUMBERING SYSTEM 品名系统

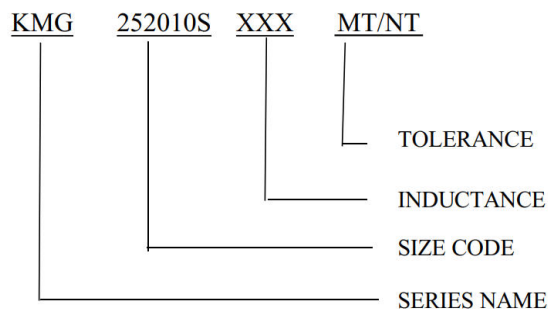

● STRUCTURAL DRAWING 结构图

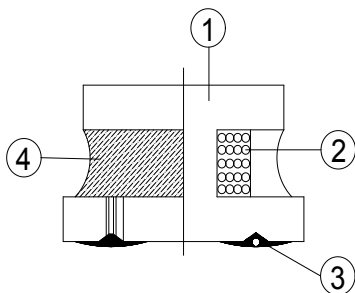

- | | |
|----------------|---------------------------|
| ① Freeite core | Ni-Zn Ferrite |
| ② Winding wire | Polyurethane-copper wire |
| ③ Electrode | External electrode |
| ④ Epoxy resin | containing ferrite powder |



SMD Power Inductors -KMG Series

● SHAPES AND DIMENSIONS 外形尺寸 (Unit:mm)

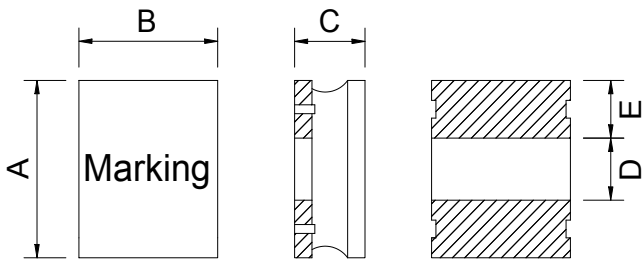

Fig 1

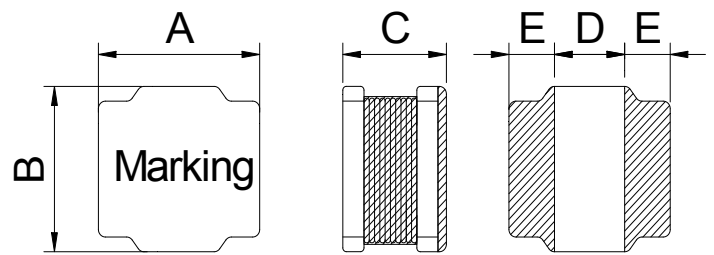

Fig 2

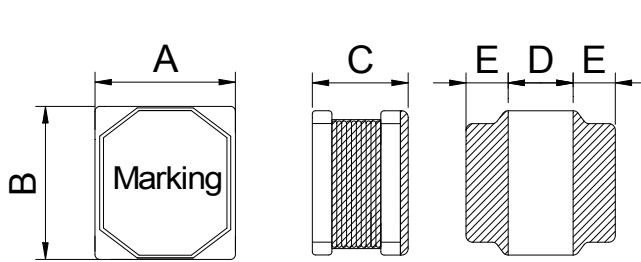
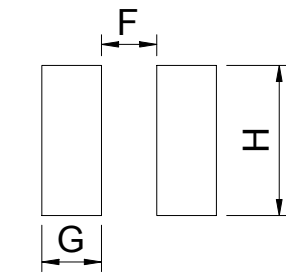

Fig 3



Recommended patterns

TYPE(型号)	A	B	C	D	E	F	G	H	Fig
KMG201610S	2.0±0.3	1.6±0.3	1.05 Max	0.6±0.2	0.77±0.2	0.6	0.8	1.8	1
KMG252010S	2.5±0.3	2.0±0.3	1.05 Max	0.8±0.3	0.9±0.3	0.6	1.1	2.0	1
KMG252012S	2.5±0.3	2.0±0.3	1.25 Max	0.8±0.3	0.9±0.3	0.6	1.1	2.0	1
KMG3010S	3.0±0.2	3.0±0.2	1.1 Max	1.2±0.3	0.9±0.3	1.1	1.0	2.7	3
KMG3012S	3.0±0.2	3.0±0.2	1.3 Max	1.2±0.3	0.9±0.3	1.1	1.0	2.7	3
KMG3015S	3.0±0.2	3.0±0.2	1.7 Max	1.2±0.3	0.9±0.3	1.1	1.0	2.7	3
KMG4012S	4.0±0.2	4.0±0.2	1.2 Max	1.6±0.3	1.2±0.3	1.4	1.3	3.7	3
KMG4018S	4.0±0.2	4.0±0.2	1.8 Max	1.6±0.3	1.2±0.3	1.4	1.3	3.7	3
KMG4020S	4.0±0.2	4.0±0.2	2.0 Max	1.6±0.3	1.2±0.3	1.4	1.3	3.7	3
KMG4030S	4.0±0.2	4.0±0.2	3.0 Max	1.3±0.3	1.35±0.3	1.2	1.40	3.7	3
KMG5020S	5.0±0.2	5.0±0.2	2.1 Max	1.4±0.3	1.8±0.3	1.2	1.9	4.2	2
KMG5040S	5.0±0.2	5.0±0.2	4.0 Max	1.6±0.3	1.7±0.3	1.4	1.8	4.2	3
KMG6020S	6.0±0.3	6.0±0.3	2.1 Max	2.3±0.3	1.85±0.3	2.4	1.8	5.7	2
KMG6028S	6.0±0.3	6.0±0.3	3.0 Max	2.3±0.3	1.85±0.3	2.4	1.8	5.7	2
KMG6045S	6.0±0.3	6.0±0.3	4.7 Max	2.3±0.3	1.85±0.3	2.4	1.8	5.7	2
KMG8040S	8.0±0.3	8.0±0.3	4.2 Max	3.8±0.3	2.1±0.3	3.6	2.2	7.5	2



SMD Power Inductors -KMG Series

● SPECIFICATION TABLE:

PART NUMBER 品名	INDUCTANCE (μ H) 电感值	DCR (Max.) (Ω) 直流电阻	Isat (Max.) (A) 饱和电流	Irms (Max.) (A) 额定电流	Marker 印字
KMG201610S-R47N	0.47 \pm 30%	0.059	2.30	2.35	/
KMG201610S-R68N	0.68 \pm 30%	0.076	1.95	2.05	/
KMG201610S-1R0N	1.0 \pm 30%	0.114	1.65	1.45	/
KMG201610S-1R5N	1.5 \pm 30%	0.174	1.35	1.25	/
KMG201610S-2R2M	2.2 \pm 20%	0.264	1.20	1.10	/
KMG201610S-3R3M	3.3 \pm 20%	0.335	0.90	0.88	/
KMG201610S-4R7M	4.7 \pm 20%	0.479	0.70	0.74	/
KMG201610S-6R8M	6.8 \pm 20%	0.816	0.60	0.52	/
KMG201610S-100M	10 \pm 20%	1.020	0.50	0.45	/

PART NUMBER 品名	INDUCTANCE (μ H) 电感值	DCR (Max.) (Ω) 直流电阻	Isat (Max.) (A) 饱和电流	Irms (Max.) (A) 额定电流	Marker 印字
KMG252010S-1R0N	1.0 \pm 30%	0.108	1.85	1.65	/
KMG252010S-1R5N	1.5 \pm 30%	0.182	1.80	1.30	/
KMG252010S-2R2N	2.2 \pm 30%	0.209	1.20	1.20	/
KMG252010S-3R3M	3.3 \pm 20%	0.328	1.05	0.90	/
KMG252010S-4R7M	4.7 \pm 20%	0.563	0.95	0.70	/
KMG252010S-5R6M	5.6 \pm 20%	0.563	0.80	0.73	/
KMG252010S-6R8M	6.8 \pm 20%	0.896	0.78	0.59	/
KMG252010S-100M	10 \pm 20%	1.092	0.65	0.50	/
KMG252010S-150M	15 \pm 20%	1.885	0.46	0.36	/
KMG252010S-220M	22 \pm 20%	2.400	0.45	0.30	/

Remark: 1. Inductance Tested at 1MHz, 0.25Vrms (20°C)

2. Isat: DC current at which the inductance drops approximate 30% from its value without current;
3. Irms: DC current that causes the temperature rise ($\Delta T = 40^\circ\text{C}$) from 25°C ambient.
4. Operating Temperature : $-25^\circ\text{C} \sim +125^\circ\text{C}$



SMD Power Inductors -KMG Series

● SPECIFICATION TABLE:

PART NUMBER 品名	INDUCTANCE (μ H) 电感值	DCR (Max.) (Ω) 直流电阻	Isat (Max.) (A) 饱和电流	Irms (Max.) (A) 额定电流	Marker 印字
KMG252012S-R47N	0.47 \pm 30%	0.061	3.82	2.15	/
KMG252012S-R68N	0.68 \pm 30%	0.074	3.28	1.95	/
KMG252012S-1R0N	1.0 \pm 30%	0.09	2.59	1.93	/
KMG252012S-1R0N	1.2 \pm 30%	0.129	2.38	1.46	/
KMG252012S-1R5N	1.5 \pm 30%	0.147	2.24	1.40	/
KMG252012S-2R2N	2.2 \pm 30%	0.216	1.85	1.15	/
KMG252012S-3R3M	3.3 \pm 20%	0.264	1.61	1.04	/
KMG252012S-4R7M	4.7 \pm 20%	0.377	1.12	0.84	/
KMG252012S-5R6M	5.6 \pm 20%	0.538	1.11	0.73	/
KMG252012S-6R8M	6.8 \pm 20%	0.581	0.98	0.69	/
KMG252012S-8R2M	8.2 \pm 20%	0.658	0.98	0.65	/
KMG252012S-100M	10 \pm 20%	0.69	0.79	0.62	/
KMG252012S-120M	12 \pm 20%	1.075	0.78	0.51	/
KMG252012S-150M	15 \pm 20%	1.591	0.68	0.42	/
KMG252012S-220M	22 \pm 20%	1.976	0.53	0.38	/

Remark: 1. Inductance Tested at 1MHz, 0.25Vrms (20°C)

2. Isat: DC current at which the inductance drops approximate 30% from its value without current;
3. Irms: DC current that causes the temperature rise ($\Delta T = 40^\circ\text{C}$) from 25°C ambient.
4. Operating Temperature : $-25^\circ\text{C} \sim +125^\circ\text{C}$



SMD Power Inductors -KMG Series

● SPECIFICATION TABLE:

PART NUMBER 品名	INDUCTANCE (μ H) 电感值	DCR (\pm 30%) (Ω) 直流电阻	Isat (Max.) (A) 饱和电流	Irms (Max.) (A) 额定电流	S.R.F.(Min.) (MHz) 自谐频率
KMG3010S-1R0N	1.0 \pm 30%	0.065	1.40	1.45	180
KMG3010S-1R5N	1.5 \pm 30%	0.080	1.27	1.30	120
KMG3010S-2R2N	2.2 \pm 30%	0.110	1.15	1.09	100
KMG3010S-3R3M	3.3 \pm 20%	0.145	0.97	0.96	74
KMG3010S-4R7M	4.7 \pm 20%	0.225	0.75	0.77	59
KMG3010S-6R8M	6.8 \pm 20%	0.305	0.55	0.66	42
KMG3010S-100M	10 \pm 20%	0.400	0.55	0.58	39
KMG3010S-150M	15 \pm 20%	0.610	0.42	0.47	30
KMG3010S-220M	22 \pm 20%	0.930	0.35	0.38	28
KMG3010S-330M	33 \pm 20%	1.550	0.29	0.30	18
KMG3010S-470M	47 \pm 20%	1.950	0.22	0.26	18

PART NUMBER 品名	INDUCTANCE (μ H) 电感值	DCR (\pm 30%) (Ω) 直流电阻	Isat (Max.) (A) 饱和电流	Irms (Max.) (A) 额定电流	S.R.F.(Min.) (MHz) 自谐频率
KMG3012S-1R0N	1.0 \pm 30%	0.040	1.87	2.20	120
KMG3012S-1R5N	1.5 \pm 30%	0.045	1.62	2.01	110
KMG3012S-2R2N	2.2 \pm 30%	0.075	1.20	1.55	84
KMG3012S-3R3M	3.3 \pm 20%	0.100	1.05	1.36	64
KMG3012S-4R7M	4.7 \pm 20%	0.120	0.90	1.24	61
KMG3012S-6R8M	6.8 \pm 20%	0.190	0.75	0.98	61
KMG3012S-100M	10 \pm 20%	0.265	0.60	0.83	42
KMG3012S-150M	15 \pm 20%	0.360	0.45	0.71	27
KMG3012S-220M	22 \pm 20%	0.645	0.42	0.53	23
KMG3012S-330M	33 \pm 20%	0.875	0.36	0.46	18
KMG3012S-470M	47 \pm 20%	1.450	0.27	0.35	14
KMG3012S-680M	68 \pm 20%	1.670	0.24	0.33	12

Remark: 1. Inductance Tested at 100kHz, 1Vrms (20 $^{\circ}$ C)

2. Isat: DC current at which the inductance drops approximate 30% from its value without current;
3. Irms: DC current that causes the temperature rise (Δ T =40 $^{\circ}$ C) from 25 $^{\circ}$ C ambient.
4. Operating Temperature : -25 $^{\circ}$ C ~ +125 $^{\circ}$ C



SMD Power Inductors -KMG Series

● SPECIFICATION TABLE:

PART NUMBER 品名	INDUCTANCE (μ H) 电感值	DCR (\pm 30%) (Ω) 直流电阻	Isat (Max.) (A) 饱和电流	Irms (Max.) (A) 额定电流	S.R.F.(Min.) (MHz) 自谐频率
KMG3015S-1R0N	1.0 \pm 30%	0.039	2.32	2.35	150
KMG3015S-1R2N	1.2 \pm 30%	0.040	2.21	1.95	110
KMG3015S-1R5N	1.5 \pm 30%	0.050	2.00	1.70	100
KMG3015S-1R8N	1.8 \pm 30%	0.050	1.75	1.70	92
KMG3015S-2R2N	2.2 \pm 30%	0.060	1.60	1.60	86
KMG3015S-3R3M	3.3 \pm 20%	0.080	1.32	1.36	68
KMG3015S-4R7M	4.7 \pm 20%	0.125	1.10	1.09	46
KMG3015S-6R8M	6.8 \pm 20%	0.200	0.85	0.85	39
KMG3015S-100M	10 \pm 20%	0.250	0.72	0.77	41
KMG3015S-120M	12 \pm 20%	0.320	0.70	0.68	32
KMG3015S-150M	15 \pm 20%	0.350	0.66	0.65	30
KMG3015S-180M	18 \pm 20%	0.430	0.56	0.59	23
KMG3015S-220M	22 \pm 20%	0.460	0.52	0.57	23
KMG3015S-330M	33 \pm 20%	0.820	0.44	0.43	20
KMG3015S-470M	47 \pm 20%	1.250	0.35	0.35	14

Remark: 1. Inductance Tested at 100kHz, 1Vrms (20°C)

2. Isat: DC current at which the inductance drops approximate 30% from its value without current;

3. Irms: DC current that causes the temperature rise ($\Delta T = 40^\circ C$) from 25°C ambient.

4. Operating Temperature : -25°C ~ +125°C



SMD Power Inductors -KMG Series

● SPECIFICATION TABLE:

PART NUMBER 品名	INDUCTANCE (μ H) 电感值	DCR (\pm 30%) (Ω) 直流电阻	Isat (Max.) (A) 饱和电流	Irms (Max.) (A) 额定电流	S.R.F.(Min.) (MHz) 自谐频率
KMG4012S-R82N	0.82 \pm 30%	0.050	3.02	1.65	150
KMG4012S-1R0N	1.0 \pm 30%	0.050	2.61	1.65	120
KMG4012S-1R5N	1.5 \pm 30%	0.065	2.10	1.46	90
KMG4012S-1R8N	1.8 \pm 30%	0.080	2.12	1.32	88
KMG4012S-2R2N	2.2 \pm 30%	0.080	1.76	1.32	74
KMG4012S-3R3N	3.3 \pm 30%	0.110	1.72	1.12	60
KMG4012S-4R7N	4.7 \pm 30%	0.125	1.15	1.05	50
KMG4012S-6R8M	6.8 \pm 20%	0.198	0.85	0.84	40
KMG4012S-100M	10 \pm 20%	0.265	0.80	0.77	33
KMG4012S-120M	12 \pm 20%	0.290	0.66	0.70	32
KMG4012S-150M	15 \pm 20%	0.340	0.56	0.64	25
KMG4012S-220M	22 \pm 20%	0.587	0.46	0.49	20
KMG4012S-330M	33 \pm 20%	0.810	0.42	0.42	17
KMG4012S-470M	47 \pm 20%	1.100	0.35	0.37	12
KMG4012S-680M	68 \pm 20%	1.950	0.38	0.27	11
KMG4012S-820M	82 \pm 20%	2.140	0.28	0.26	11
KMG4012S-101M	100 \pm 20%	2.210	0.25	0.25	9.4

Remark: 1. Inductance Tested at 100kHz, 1Vrms (20°C)

2. Isat: DC current at which the inductance drops approximate 30% from its value without current;
3. Irms: DC current that causes the temperature rise ($\Delta T = 40^\circ\text{C}$) from 25°C ambient.
4. Operating Temperature : $-25^\circ\text{C} \sim +125^\circ\text{C}$



SMD Power Inductors -KMG Series

● SPECIFICATION TABLE:

PART NUMBER 品名	INDUCTANCE (μ H) 电感值	DCR (\pm 30%) (Ω) 直流电阻	Isat (Max.) (A) 饱和电流	Irms (Max.) (A) 额定电流	S.R.F.(Min.) (MHz) 自谐频率
KMG4018S-1R0N	1.0 \pm 30%	0.025	4.20	2.00	80
KMG4018S-1R5N	1.5 \pm 30%	0.030	3.35	1.80	65
KMG4018S-2R2M	2.2 \pm 20%	0.045	2.70	1.65	52
KMG4018S-3R3M	3.3 \pm 20%	0.070	2.45	1.23	44
KMG4018S-4R7M	4.7 \pm 20%	0.090	1.70	1.20	34
KMG4018S-6R8M	6.8 \pm 20%	0.110	1.45	1.06	29
KMG4018S-100M	10 \pm 20%	0.180	1.30	0.84	24
KMG4018S-150M	15 \pm 20%	0.250	0.94	0.65	19
KMG4018S-220M	22 \pm 20%	0.360	0.80	0.59	16
KMG4018S-330M	33 \pm 20%	0.530	0.56	0.49	12
KMG4018S-470M	47 \pm 20%	0.650	0.57	0.42	10
KMG4018S-680M	68 \pm 20%	1.000	0.47	0.32	8.3
KMG4018S-101M	100 \pm 20%	1.750	0.40	0.25	6.5
KMG4018S-151M	150 \pm 20%	2.500	0.31	0.22	5.5
KMG4018S-221M	220 \pm 20%	4.000	0.27	0.17	4.0
KMG4018S-331M	330 \pm 20%	6.500	0.20	0.14	2.2

Remark: 1. Inductance Tested at 100kHz, 1Vrms (20 $^{\circ}$ C)

2. Isat: DC current at which the inductance drops approximate 30% from its value without current;

3. Irms: DC current that causes the temperature rise (Δ T =40 $^{\circ}$ C) from 25 $^{\circ}$ C ambient.

4. Operating Temperature : -25 $^{\circ}$ C ~ +125 $^{\circ}$ C



SMD Power Inductors -KMG Series

● SPECIFICATION TABLE:

PART NUMBER 品名	INDUCTANCE (μ H) 电感值	DCR (\pm 30%) (Ω) 直流电阻	Isat (Max.) (A) 饱和电流	Irms (Max.) (A) 额定电流	S.R.F.(Min.) (MHz) 自谐频率
KMG4020S-1R0N	1.0 \pm 30%	0.029	4.78	2.15	75
KMG4020S-1R2N	1.2 \pm 30%	0.029	5.10	2.15	72
KMG4020S-1R5N	1.5 \pm 30%	0.035	4.45	1.98	71
KMG4020S-2R2N	2.2 \pm 30%	0.040	3.40	1.85	49
KMG4020S-3R3M	3.3 \pm 20%	0.070	3.20	1.40	44
KMG4020S-4R7M	4.7 \pm 20%	0.075	2.35	1.34	42
KMG4020S-5R6M	5.6 \pm 20%	0.090	2.20	1.22	30
KMG4020S-6R8M	6.8 \pm 20%	0.125	2.00	1.04	33
KMG4020S-8R2M	8.2 \pm 20%	0.125	1.75	1.04	27
KMG4020S-100M	10 \pm 20%	0.165	1.60	0.90	26
KMG4020S-150M	15 \pm 20%	0.230	1.35	0.77	24
KMG4020S-220M	22 \pm 20%	0.350	1.05	0.62	15
KMG4020S-330M	33 \pm 20%	0.550	0.85	0.49	11
KMG4020S-470M	47 \pm 20%	0.710	0.74	0.44	10
KMG4020S-560M	56 \pm 20%	0.800	0.66	0.41	10
KMG4020S-680M	68 \pm 20%	1.060	0.61	0.36	7.7
KMG4020S-820M	82 \pm 20%	1.170	0.50	0.34	7.2
KMG4020S-101M	100 \pm 20%	1.550	0.48	0.31	6.3

Remark: 1. Inductance Tested at 100kHz, 1Vrms (20 $^{\circ}$ C)

2. Isat: DC current at which the inductance drops approximate 30% from its value without current;

3. Irms: DC current that causes the temperature rise (Δ T =40 $^{\circ}$ C) from 25 $^{\circ}$ C ambient.

4. Operating Temperature : -25 $^{\circ}$ C ~ +125 $^{\circ}$ C



SMD Power Inductors -KMG Series

● SPECIFICATION TABLE:

PART NUMBER 品名	INDUCTANCE (μ H) 电感值	DCR (\pm 30%) (Ω) 直流电阻	Isat (Max.) (A) 饱和电流	Irms (Max.) (A) 额定电流	S.R.F.(Min.) (MHz) 自谐频率
KMG4030S-1R0N	1.0 \pm 30%	0.016	5.26	4.14	70
KMG4030S-1R5N	1.5 \pm 30%	0.020	4.84	3.34	62
KMG4030S-2R2N	2.2 \pm 30%	0.030	4.40	2.95	52
KMG4030S-3R3M	3.3 \pm 20%	0.040	3.30	2.40	38
KMG4030S-4R7M	4.7 \pm 20%	0.060	2.90	2.00	31
KMG4030S-6R8M	6.8 \pm 20%	0.090	2.75	1.60	24
KMG4030S-100M	10 \pm 20%	0.100	1.95	1.50	21
KMG4030S-150M	15 \pm 20%	0.190	1.65	1.11	16
KMG4030S-220M	22 \pm 20%	0.225	1.30	1.00	10
KMG4030S-330M	33 \pm 20%	0.330	1.10	0.84	10
KMG4030S-470M	47 \pm 20%	0.445	0.95	0.72	8.4
KMG4030S-680M	68 \pm 20%	0.868	0.72	0.52	7
KMG4030S-101M	100 \pm 20%	1.150	0.60	0.45	5.6
KMG4030S-151M	150 \pm 20%	1.800	0.50	0.3	4
KMG4030S-221M	220 \pm 20%	2.500	0.40	0.35	4.2
KMG4030S-331M	330 \pm 20%	4.000	0.30	0.25	6.8
KMG4030S-471M	470 \pm 20%	7.200	0.30	0.2	2
KMG4030S-681M	680 \pm 20%	7.580	0.19	0.14	1.2

Remark: 1. Inductance Tested at 100kHz, 1Vrms (20°C)

2. Isat: DC current at which the inductance drops approximate 30% from its value without current;

3. Irms: DC current that causes the temperature rise ($\Delta T = 40^\circ\text{C}$) from 25°C ambient.

4. Operating Temperature : -25°C ~ +125°C



SMD Power Inductors -KMG Series

● SPECIFICATION TABLE:

PART NUMBER 品名	INDUCTANCE (μ H) 电感值	DCR (\pm 30%) (Ω) 直流电阻	Isat (Max.) (A) 饱和电流	Irms (Max.) (A) 额定电流	S.R.F.(Min.) (MHz) 自谐频率
KMG5020S-1R0N	1.0 \pm 30%	0.020	4.10	3.80	114
KMG5020S-1R5N	1.5 \pm 30%	0.030	4.10	3.20	68
KMG5020S-2R2N	2.2 \pm 30%	0.040	3.20	2.70	57
KMG5020S-3R3N	3.3 \pm 30%	0.050	2.55	2.30	46
KMG5020S-4R7M	4.7 \pm 20%	0.057	2.50	2.20	37
KMG5020S-6R8M	6.8 \pm 20%	0.083	2.05	1.80	30
KMG5020S-8R2M	8.2 \pm 20%	0.098	1.85	1.65	26
KMG5020S-100M	10 \pm 20%	0.120	1.70	1.55	24
KMG5020S-150M	15 \pm 20%	0.165	1.35	1.25	20
KMG5020S-180M	18 \pm 20%	0.200	1.25	1.15	16
KMG5020S-220M	22 \pm 20%	0.250	1.15	1.10	14
KMG5020S-330M	33 \pm 20%	0.400	0.92	0.90	10
KMG5020S-470M	47 \pm 20%	0.580	0.77	0.75	7
KMG5020S-680M	68 \pm 20%	0.740	0.65	0.64	6
KMG5020S-101M	100 \pm 20%	1.100	0.53	0.40	6

Remark: 1. Inductance Tested at 100kHz, 1Vrms (20°C)

2. Isat: DC current at which the inductance drops approximate 30% from its value without current;

3. Irms: DC current that causes the temperature rise ($\Delta T = 40^\circ\text{C}$) from 25°C ambient.

4. Operating Temperature : -25°C ~ +125°C



SMD Power Inductors -KMG Series

● SPECIFICATION TABLE:

PART NUMBER 品名	INDUCTANCE (μ H) 电感值	DCR (\pm 30%) (Ω) 直流电阻	Isat (Max.) (A) 饱和电流	Irms (Max.) (A) 额定电流	S.R.F.(Min.) (MHz) 自谐频率
KMG5040S-1R0N	1.0 \pm 30%	0.012	7.35	4.90	117
KMG5040S-1R2N	1.2 \pm 30%	0.016	6.50	4.15	110
KMG5040S-1R5N	1.5 \pm 30%	0.018	6.30	4.00	86
KMG5040S-2R2N	2.2 \pm 30%	0.019	4.90	3.80	50
KMG5040S-3R3N	3.3 \pm 30%	0.024	3.95	3.40	32
KMG5040S-4R7M	4.7 \pm 20%	0.032	3.50	3.00	28
KMG5040S-5R6M	5.6 \pm 20%	0.035	3.00	2.80	27
KMG5040S-6R8M	6.8 \pm 20%	0.043	2.90	2.50	21
KMG5040S-100M	10 \pm 20%	0.064	2.35	2.10	18
KMG5040S-150M	15 \pm 20%	0.086	2.00	2.00	13
KMG5040S-220M	22 \pm 20%	0.129	1.60	1.50	11
KMG5040S-330M	33 \pm 20%	0.188	1.30	1.20	9.1
KMG5040S-470M	47 \pm 20%	0.272	1.10	1.00	6.7
KMG5040S-680M	68 \pm 20%	0.400	0.90	0.80	5.7
KMG5040S-101M	100 \pm 20%	0.560	0.75	0.70	4.7
KMG5040S-151M	150 \pm 20%	0.750	0.65	0.60	5
KMG5040S-221M	220 \pm 20%	1.280	0.40	0.38	3
KMG5040S-102M	1000 \pm 20%	6.200	0.25	0.25	2
KMG5040S-222M	2200 \pm 20%	13.000	0.10	0.10	2

Remark: 1. Inductance Tested at 100kHz, 1Vrms (20 $^{\circ}$ C)

2. Isat: DC current at which the inductance drops approximate 30% from its value without current;
3. Irms: DC current that causes the temperature rise (Δ T =40 $^{\circ}$ C) from 25 $^{\circ}$ C ambient.
4. Operating Temperature : -25 $^{\circ}$ C ~ +125 $^{\circ}$ C



SMD Power Inductors -KMG Series

● SPECIFICATION TABLE:

PART NUMBER 品名	INDUCTANCE (μ H) 电感值	DCR (\pm 30%) (Ω) 直流电阻	Isat (Max.) (A) 饱和电流	Irms (Max.) (A) 额定电流	S.R.F.(Min.) (MHz) 自谐频率
KMG6020S-R68N	0.68 \pm 30%	0.017	6.55	3.80	115
KMG6020S-R82N	0.82 \pm 30%	0.017	5.30	3.80	110
KMG6020S-1R0N	1.0 \pm 30%	0.020	4.15	3.50	100
KMG6020S-1R5N	1.5 \pm 30%	0.022	4.25	3.20	79
KMG6020S-2R2N	2.2 \pm 30%	0.028	3.75	2.75	61
KMG6020S-3R3N	3.3 \pm 30%	0.035	3.15	2.60	51
KMG6020S-4R7M	4.7 \pm 20%	0.058	3.00	2.00	41
KMG6020S-6R8M	6.8 \pm 20%	0.079	2.20	1.80	31
KMG6020S-100M	10 \pm 20%	0.105	1.75	1.40	27
KMG6020S-120M	12 \pm 20%	0.120	1.45	1.30	25
KMG6020S-150M	15 \pm 20%	0.145	1.20	1.20	21
KMG6020S-180M	18 \pm 20%	0.180	1.20	1.08	18
KMG6020S-220M	22 \pm 20%	0.204	1.05	1.00	16
KMG6020S-330M	33 \pm 20%	0.300	0.95	0.84	11
KMG6020S-470M	47 \pm 20%	0.430	0.70	0.80	10

Remark: 1. Inductance Tested at 100kHz, 1Vrms (20°C)

2. Isat: DC current at which the inductance drops approximate 30% from its value without current;
3. Irms: DC current that causes the temperature rise ($\Delta T = 40^\circ\text{C}$) from 25°C ambient.
4. Operating Temperature : $-25^\circ\text{C} \sim +125^\circ\text{C}$



SMD Power Inductors -KMG Series

● SPECIFICATION TABLE:

PART NUMBER 品名	INDUCTANCE (μ H) 电感值	DCR (\pm 30%) (Ω) 直流电阻	Isat (Max.) (A) 饱和电流	Irms (Max.) (A) 额定电流	S.R.F.(Min.) (MHz) 自谐频率
KMG6028S-1R0N	1.0 \pm 30%	0.012	5.75	5.20	70
KMG6028S-1R5N	1.5 \pm 30%	0.015	6.00	4.58	65
KMG6028S-2R2N	2.2 \pm 30%	0.020	5.10	3.75	48
KMG6028S-3R3N	3.3 \pm 30%	0.025	4.15	3.48	41
KMG6028S-4R7N	4.7 \pm 30%	0.030	3.00	3.08	35
KMG6028S-6R8M	6.8 \pm 20%	0.047	2.60	2.40	27
KMG6028S-100M	10 \pm 20%	0.072	2.04	1.95	23
KMG6028S-120M	12 \pm 20%	0.080	1.80	1.85	18
KMG6028S-150M	15 \pm 20%	0.125	1.75	1.45	18
KMG6028S-180M	18 \pm 20%	0.120	1.52	1.45	15
KMG6028S-220M	22 \pm 20%	0.140	1.45	1.40	14
KMG6028S-330M	33 \pm 20%	0.185	1.35	1.22	12
KMG6028S-470M	47 \pm 20%	0.315	1.15	1.06	9.5
KMG6028S-680M	68 \pm 20%	0.360	0.80	0.86	7.7
KMG6028S-820M	82 \pm 20%	0.500	0.80	0.70	7.7
KMG6028S-101M	100 \pm 20%	0.500	0.65	0.70	7.1
KMG6028S-102M	1000 \pm 20%	5.800	0.18	0.20	1.5

Remark: 1. Inductance Tested at 100kHz, 1Vrms (20°C)

2. Isat: DC current at which the inductance drops approximate 30% from its value without current;

3. Irms: DC current that causes the temperature rise ($\Delta T = 40^\circ\text{C}$) from 25°C ambient.

4. Operating Temperature : -25°C ~ +125°C



SMD Power Inductors -KMG Series

● SPECIFICATION TABLE:

PART NUMBER 品名	INDUCTANCE (μ H) 电感值	DCR (\pm 30%) (Ω) 直流电阻	Isat (Max.) (A) 饱和电流	Irms (Max.) (A) 额定电流	S.R.F.(Min.) (MHz) 自谐频率
KMG6045S-1R0N	1.0 \pm 30%	0.011	9.85	5.14	100
KMG6045S-1R5N	1.5 \pm 30%	0.012	8.80	4.95	65
KMG6045S-2R2N	2.2 \pm 30%	0.014	6.75	4.60	52
KMG6045S-3R3N	3.3 \pm 30%	0.024	5.90	3.70	32
KMG6045S-4R7M	4.7 \pm 20%	0.031	4.97	3.30	24
KMG6045S-6R8M	6.8 \pm 20%	0.035	3.90	3.00	20
KMG6045S-100M	10 \pm 20%	0.048	3.20	2.45	15
KMG6045S-150M	15 \pm 20%	0.068	2.50	2.05	12
KMG6045S-220M	22 \pm 20%	0.089	2.05	1.80	10
KMG6045S-330M	33 \pm 20%	0.137	1.65	1.45	7.8
KMG6045S-470M	47 \pm 20%	0.200	1.40	1.20	6.4
KMG6045S-560M	56 \pm 20%	0.221	1.30	1.10	6.4
KMG6045S-680M	68 \pm 20%	0.289	1.20	1.00	6.4
KMG6045S-101M	100 \pm 20%	0.433	0.95	0.80	4.2
KMG6045S-121M	120 \pm 20%	0.484	0.85	0.77	4.2
KMG6045S-151M	150 \pm 20%	0.580	0.80	0.70	4.2
KMG6045S-221M	220 \pm 20%	0.834	0.70	0.59	3.5
KMG6045S-331M	330 \pm 20%	1.270	0.57	0.57	2.8
KMG6045S-471M	470 \pm 20%	1.800	0.50	0.42	2
KMG6045S-681M	680 \pm 20%	2.500	0.42	0.33	1.7
KMG6045S-102M	1000 \pm 20%	4.500	0.30	0.30	1.4
KMG6045S-152M	1500 \pm 20%	6.500	0.24	0.21	0.8

Remark: 1. Inductance Tested at 100kHz, 1Vrms (20°C)

2. Isat: DC current at which the inductance drops approximate 30% from its value without current;

3. Irms: DC current that causes the temperature rise ($\Delta T = 40^\circ\text{C}$) from 25°C ambient.

4. Operating Temperature : $-25^\circ\text{C} \sim +125^\circ\text{C}$



SMD Power Inductors -KMG Series

● SPECIFICATION TABLE:

PART NUMBER 品名	INDUCTANCE (μ H) 电感值	DCR (\pm 30%) (Ω) 直流电阻	Isat (Max.) (A) 饱和电流	Irms (Max.) (A) 额定电流	S.R.F.(Min.) (MHz) 自谐频率
KMG8040S-R82N	0.82 \pm 30%	0.008	13.80	6.30	94
KMG8040S-1R0N	1.0 \pm 30%	0.008	9.85	6.30	89
KMG8040S-1R5N	1.5 \pm 30%	0.010	8.15	5.65	67
KMG8040S-2R2N	2.2 \pm 30%	0.012	7.10	5.15	41
KMG8040S-3R3N	3.3 \pm 30%	0.017	6.50	4.40	27
KMG8040S-4R7N	4.7 \pm 30%	0.019	5.90	4.10	24
KMG8040S-6R8M	6.8 \pm 20%	0.024	4.55	3.60	20
KMG8040S-8R2M	8.2 \pm 20%	0.026	4.20	3.45	17
KMG8040S-100M	10 \pm 20%	0.042	3.60	3.30	15
KMG8040S-150M	15 \pm 20%	0.047	2.95	2.60	12
KMG8040S-180M	18 \pm 20%	0.053	2.70	2.40	11
KMG8040S-220M	22 \pm 20%	0.069	2.40	2.10	9.5
KMG8040S-330M	33 \pm 20%	0.097	2.05	1.80	7.8
KMG8040S-470M	47 \pm 20%	0.136	1.75	1.55	6.4
KMG8040S-680M	68 \pm 20%	0.196	1.45	1.25	4.9
KMG8040S-820M	82 \pm 20%	0.225	1.30	1.15	4.9
KMG8040S-101M	100 \pm 20%	0.290	1.15	1.00	4.2
KMG8040S-121M	120 \pm 20%	0.334	1.05	0.95	3.5
KMG8040S-151M	150 \pm 20%	0.410	1.10	0.85	3.5
KMG8040S-221M	220 \pm 20%	0.599	0.85	0.80	3.5
KMG8040S-331M	330 \pm 20%	0.889	0.68	0.64	2.8
KMG8040S-471M	470 \pm 20%	1.260	0.60	0.54	2.1
KMG8040S-681M	680 \pm 20%	2.040	0.50	0.45	1.7
KMG8040S-102M	1000 \pm 20%	2.800	0.40	0.35	1.4

Remark: 1. Inductance Tested at 100kHz, 1Vrms (20°C)

2. Isat: DC current at which the inductance drops approximate 30% from its value without current;
3. Irms: DC current that causes the temperature rise ($\Delta T = 40^\circ C$) from 25°C ambient.
4. Operating Temperature : -25°C ~ +125°C



SMD Power Inductors -KMG Series

● PACKAGING SPECIFICATION :

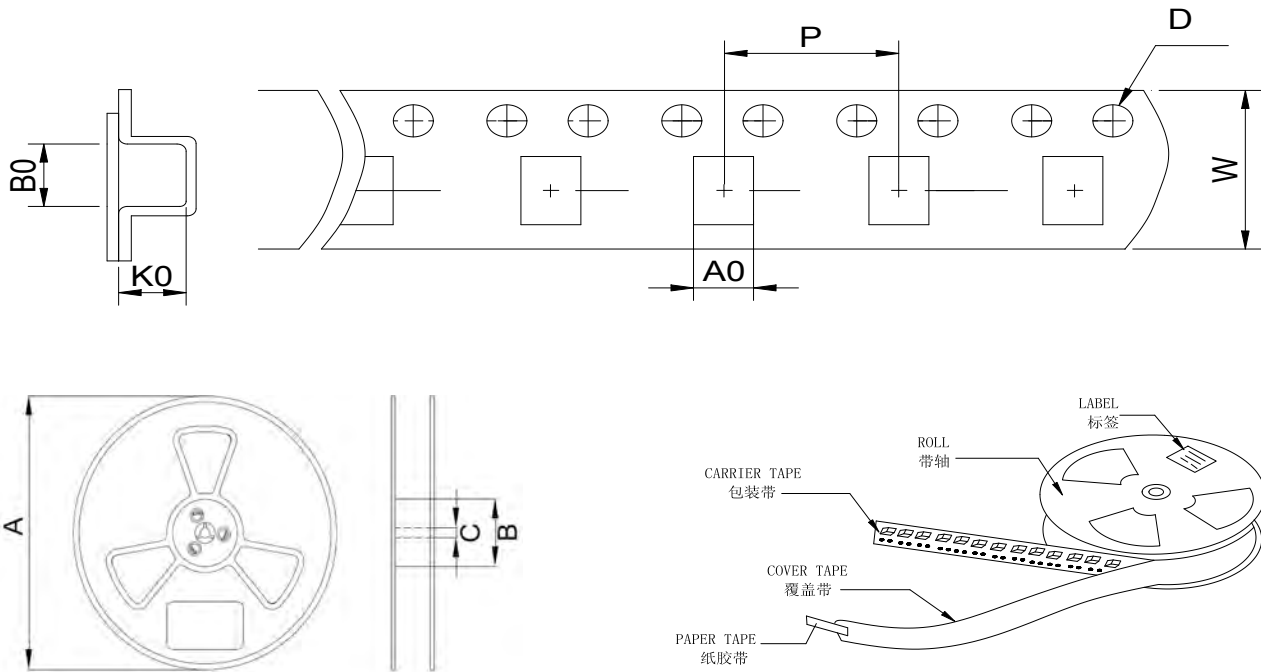

Type	Tape Dimension (mm)						Reel Dimension (mm)			Quantity (Pcs/Reel)
	W	A0	B0	K0	D	P	A	B	C	
KMG201610S	8	1.9	2.3	1.2	1.5	4	178	58	13	2000
KMG252010S	8	2.4	2.9	1.25	1.5	4	178	58	13	2000
KMG252012S	8	2.35	2.65	1.6	1.5	4	178	58	13	2000
KMG3010S	8	3.3	3.3	1.4	1.5	4	178	58	13	2000
KMG3012S	8	3.3	3.3	1.6	1.5	4	178	58	13	2000
KMG3015S	8	3.3	3.3	1.9	1.5	4	178	58	13	2000
KMG4012S	12	4.3	4.3	1.4	1.5	8	330	100	13	4500
KMG4018S	12	4.3	4.3	2.2	1.5	8	330	100	13	3000
KMG4020S	12	4.3	4.3	2.4	1.5	8	330	100	13	3000
KMG4030S	12	4.3	4.3	3.4	1.5	8	330	100	13	2000
KMG5020S	12	5.4	5.4	2.4	1.5	8	330	100	13	3000
KMG5040S	12	5.4	5.4	4.4	1.5	8	330	100	13	1500
KMG6020S	16	6.4	6.4	2.4	1.5	8	330	100	13	2500
KMG6028S	16	6.4	6.4	3.2	1.5	8	330	100	13	2000
KMG6045S	16	6.4	6.4	4.8	1.5	8	330	100	13	1500
KMG8040S	16	8.4	8.4	4.4	1.5	12	330	100	13	1000