

### FEATURES:

- ✧ Planar technology.
- ✧ Halogen-free and RoHS compliant.
- ✧ Stand-off voltage: 3.3V.
- ✧ 200W peak pulse power capability at 10/1000µs waveform.
- ✧ Meets MSL level 1, per J-STD-020, LF maximum peak of 260°C.
- ✧ Terminal: solder plated, solderable per J-STD-002.
- ✧ Excellent clamping capability.
- ✧ Fast response time.

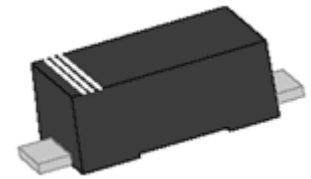

SOD-123FL



Uni-directional

Symbol

### ABSOLUTE MAXIMUM RATINGS (T<sub>A</sub>=25°C, RH=45%-75%, unless otherwise noted)

Parameter	Symbol	Value	Unit
Storage and operating junction temperature range	T <sub>STG</sub> / T <sub>J</sub>	-55 to +150	°C
Peak pulse power dissipation on 10/1000µs waveform	P <sub>PP</sub>	200	W
Typical thermal resistance junction to lead	R <sub>θJL</sub>	100	°C/W
Typical thermal resistance junction to ambient	R <sub>θJA</sub>	220	°C/W

### MARKING

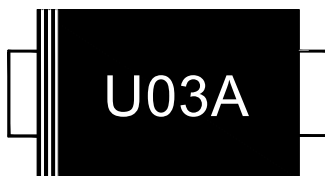

U03A : Device Marking Code

### ELECTRICAL CHARACTERISTICS (T<sub>A</sub>=25°C)

Part Number	V <sub>R</sub>	I <sub>R</sub> @V <sub>R</sub>	V <sub>BR</sub> @I <sub>T</sub>	I <sub>T</sub>	V <sub>C</sub> @I <sub>PP</sub>	I <sub>PP</sub> <sup>①</sup>	Co <sup>②</sup>	Marking
	V	µA	V (min)	mA	V (max)	A (max)	pF (typ.)	
KSMF3.3A	3.3	50	4.1	1	7.3	27	1900	U03A

① Surge waveform: 10/1000µs

② Co is measured at: V<sub>bias</sub>=0V, V<sub>RMS</sub>=0.1V, f=1MHz

## ORDERING INFORMATION

<b>KSMF</b>	<b>3.3</b>	<b>A</b>
200W SOD-123FL Series	$V_R$ Voltage	5% $V_{BR}$ voltage tolerance

## RATINGS AND V-I CHARACTERISTICS CURVES ( $T_A=25^\circ\text{C}$ , unless otherwise noted)

**FIG.1: V- I curve characteristics (Uni-directional)**

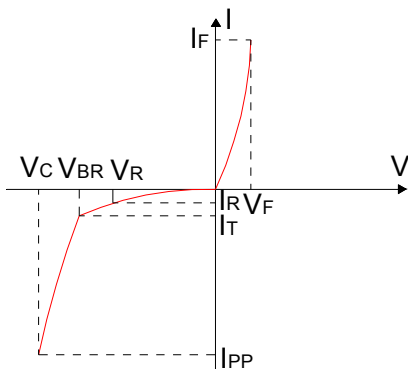

**FIG.2: Pulse waveform**

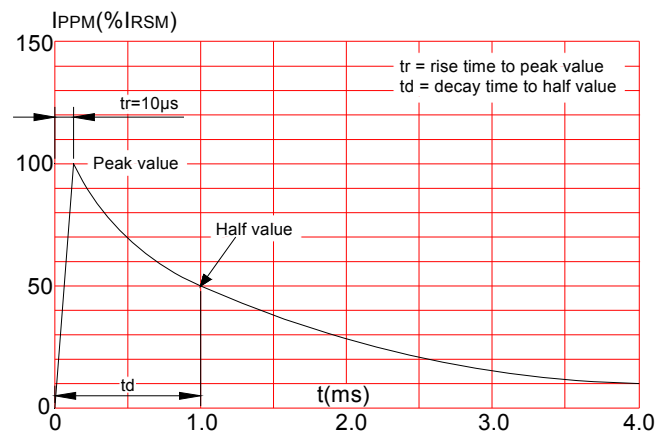

**FIG.3: Pulse derating curve**

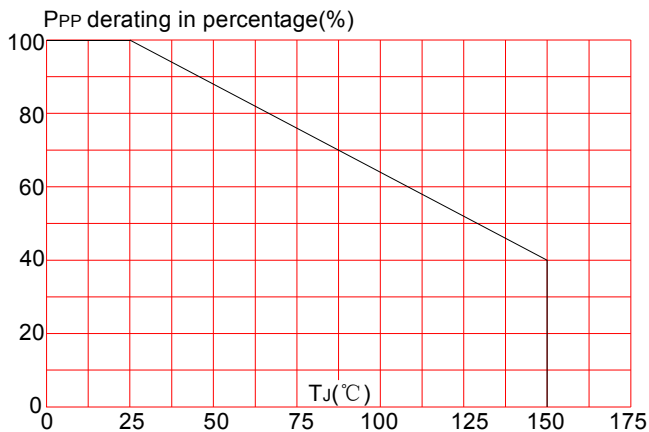

# KSMF3.3A

## SOLDERING PARAMETERS

Reflow Condition		Pb-Free assembly (see figure at right)
Pre Heat	-Temperature Min ( $T_{s(min)}$ )	+150°C
	-Temperature Max( $T_{s(max)}$ )	+200°C
	-Time (Min to Max) (ts)	60-180 secs.
Average ramp up rate (Liquidus Temp ( $T_L$ )to peak)		3°C/sec. Max
$T_{s(max)}$ to $T_L$ - Ramp-up Rate		3°C/sec. Max
Reflow	-Temperature( $T_L$ )(Liquidus)	+217°C
	-Temperature( $t_L$ )	60-150 secs.
Peak Temp ( $T_P$ )		+260(+0/-5)°C
Time within 5°C of actual Peak Temp ( $t_p$ )		20-40secs.
Ramp-down Rate		6°C/sec. Max
Time 25°C to Peak Temp ( $T_P$ )		8 min. Max
Do not exceed		+260°C

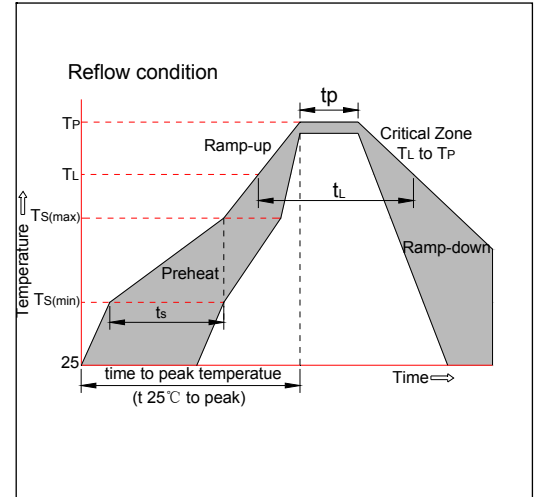

## PACKAGE MECHANICAL DATA

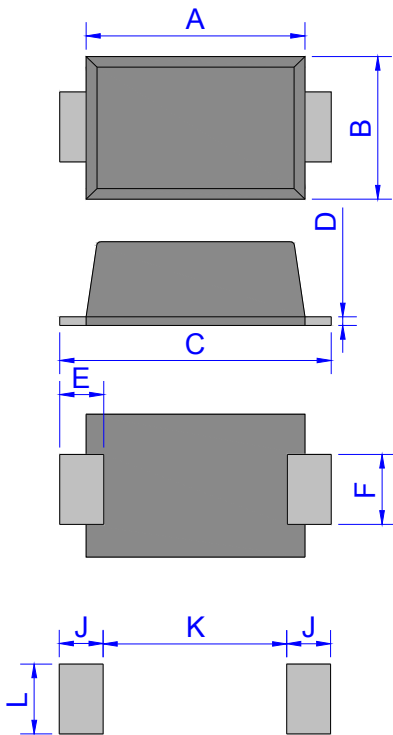

SOD-123FL

Ref.	Dimensions			
	Millimeters		Inches	
	Min.	Max.	Min.	Max.
A	2.60	3.00	0.102	0.118
B	1.60	2.00	0.063	0.079
C	3.45	3.95	0.136	0.156
D	0.10	0.25	0.004	0.01
E	0.3	0.9	0.012	0.035
F	0.80	1.20	0.031	0.047
G	0.95	1.35	0.037	0.053
J	1.30		0.051	
K		1.70		0.067
L	1.30		0.051	

## TAPE AND REEL SPECIFICATION-SOD-123FL

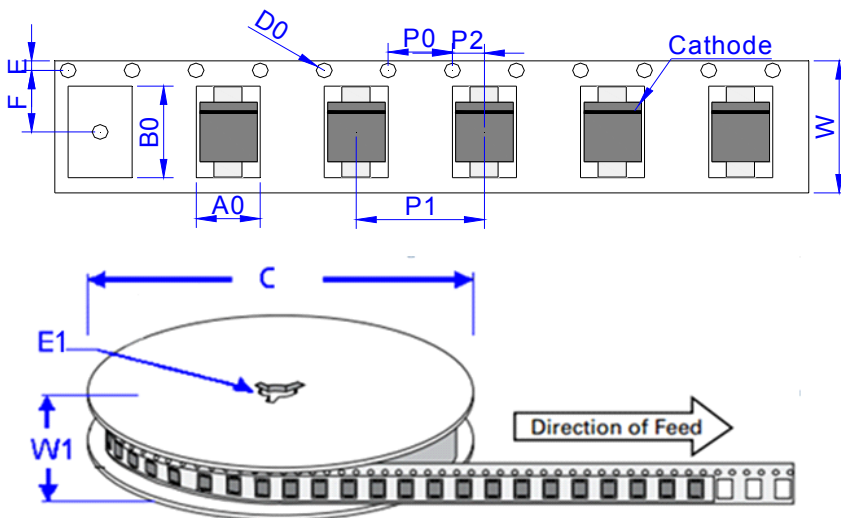

Ref.	Dimensions	
	Millimeters	Inches
A0	1.95 ± 0.3	0.077 ± 0.012
B0	3.95 ± 0.3	0.156 ± 0.012
C	178	7.0
D0	1.55 ± 0.1	0.061 ± 0.004
E	1.75 ± 0.2	0.069 ± 0.008
E1	13.3 ± 0.3	0.524 ± 0.012
F	3.50 ± 0.2	0.138 ± 0.008
P0	4.00 ± 0.2	0.157 ± 0.008
P1	4.00 ± 0.2	0.157 ± 0.008
P2	2.00 ± 0.2	0.079 ± 0.008
W	8.0 ± 0.2	0.315 ± 0.008
W1	11.5 ± 1.0	0.453 ± 0.039

PART No.	UNIT WEIGHT (g/PCS) typ.	PACKAGE	REEL (PCS)	DESCRIPTION
KSMF3.3A	0.0136	SOD-123FL	3000	7 inch reel pack